



(INTENTIONALLY BLANK)

EAST/WEST SECTION - POND EDGE & COLONNADE



3/32" = 1'  
0' 5'-4" 10'-8" 21'-4"

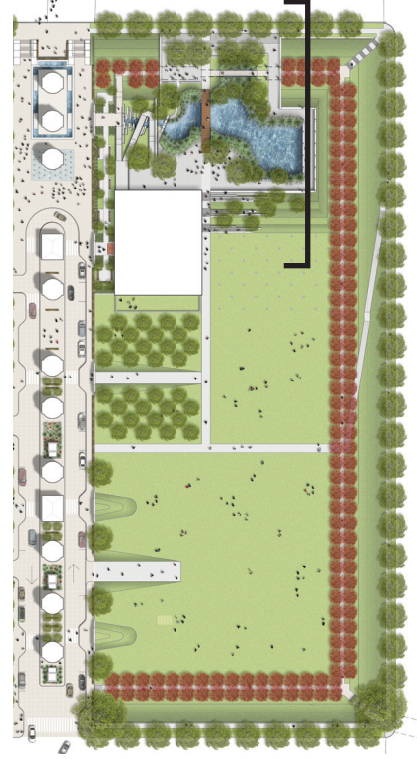

3/32" = 1'  
0' 5'-4" 10'-8" 21'-4"



EAST/WEST SECTION - POND AND AMPHITHEATER



3/32" = 1'  
0' 5'-4" 10'-8" 21'-4"



continued on next page

